

British Pavilion, Shanghai Expo 2010

With Heatherwick Studio

2197

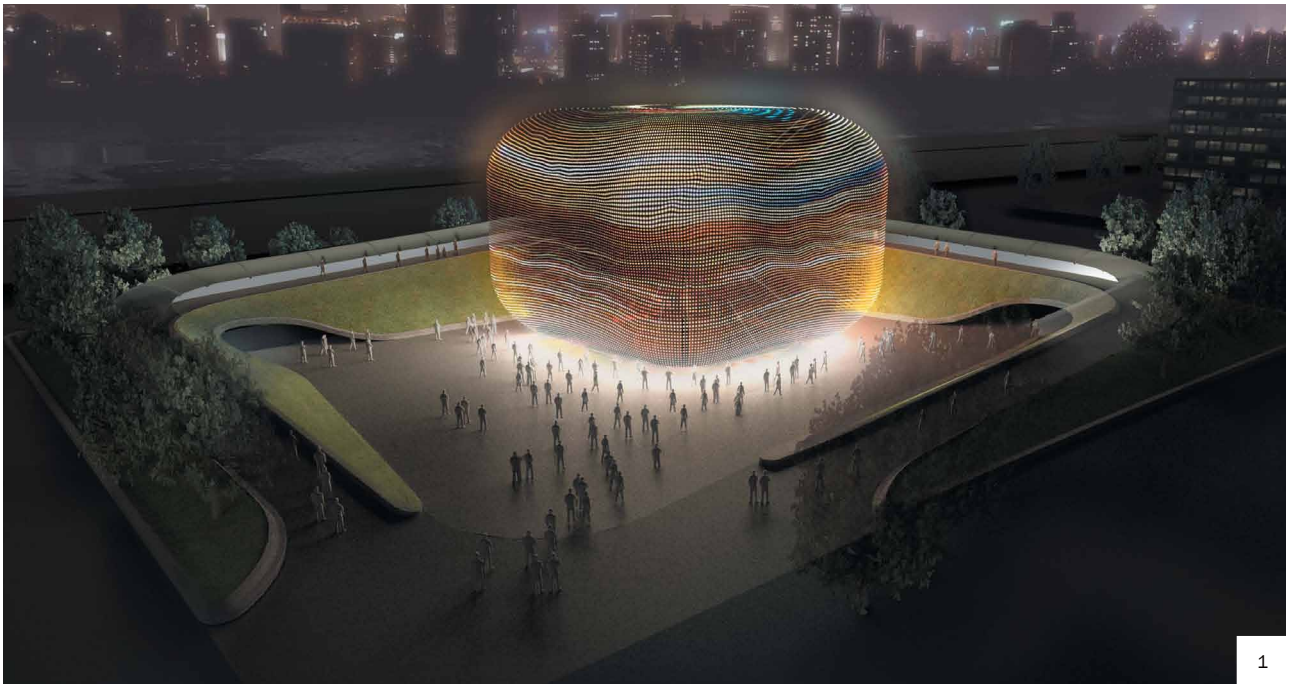

In September 2007, Atelier Ten as part of a team lead by Heatherwick Studio won the competition to design the UK Pavilion for the Shanghai 2010 Expo. The event, which will run from May to October 2010, is set to be the largest ever.

DETAILS

LOCATION: SHANGHAI
AREA: 6000 SQF
COST: £4M
DATE: 2008-2010

SERVICES

ENVIRONMENTAL DESIGN
BUILDING SERVICES

The concept is an enclosure that throws out from all faces a mass of long, radiating cilia. Their length means they gently sway in response to any wind movement. It rests on its soft forest in an urban field, surrounded by a concrete canopy that resembles unfolded wrapping paper.

The UK, with its millions of gardens, thousands of public parks and garden squares, has pioneered the integration of nature into cities as a way of making them healthier places, in which to live and work. The UK pavilion encourages visitors to look again at the role of nature and wonder whether it could be used to solve the current social, economic and environmental challenges of our cities.

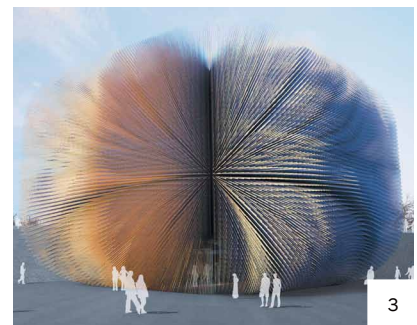
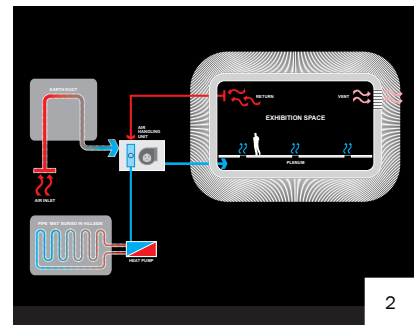

1 ARCHITECTURAL RENDERING

Competition scheme shown: 70,000 'spikes' each will have an LED located within the spike.

2 DIAGRAM

Energy efficient heat recovery air handling plant with pre-heat earth ducts.

3 ARCHITECTURAL RENDERING - DAYTIME