

# Square of the Rose Revolution

With LAB Architecture Studio

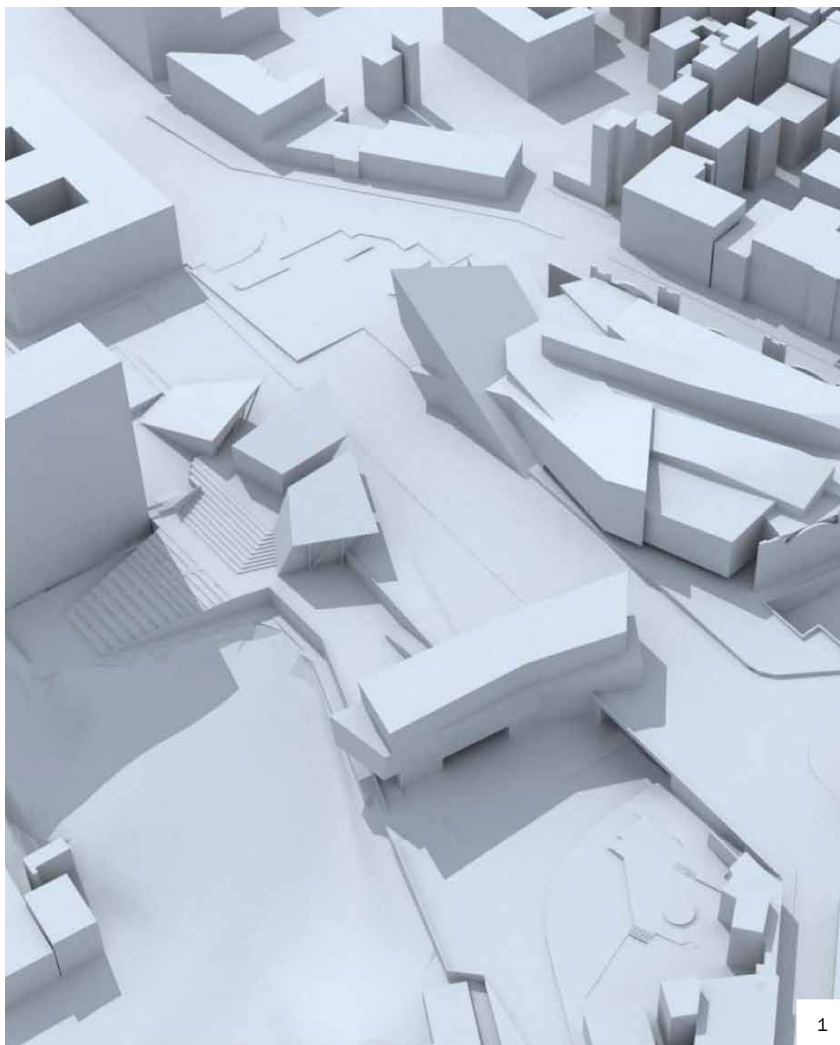

Atelier Ten devised new servicing strategies in the form of Energy, Waste, Water and Air story boards to describe the proposals to the Client and Local Authorities.

## DETAILS

LOCATION: TBLISI, GEORGIA  
DATE: 2007

## SERVICES

MASTERPLANNING

LAB architects teamed with Atelier Ten to propose environmental strategies for the civic redevelopment of the Square of the Rose Revolution in Tbilisi, Georgia. Existing services to the square and its surrounding buildings required a significant overhaul. The square is raised over a disused underground retail shopping centre and provided the opportunity to introduce energy piles underground.

The surrounding buildings were mixed use including hotel, residential properties, restaurant, retail, cinema, bars, health spa and offices. The different load profiles of the proposed uses were analysed and assessed to optimise the energy, waste and water strategies proposed. Rapid analysis was employed to allow for different combinations of building uses and loads to inform the final design mix.

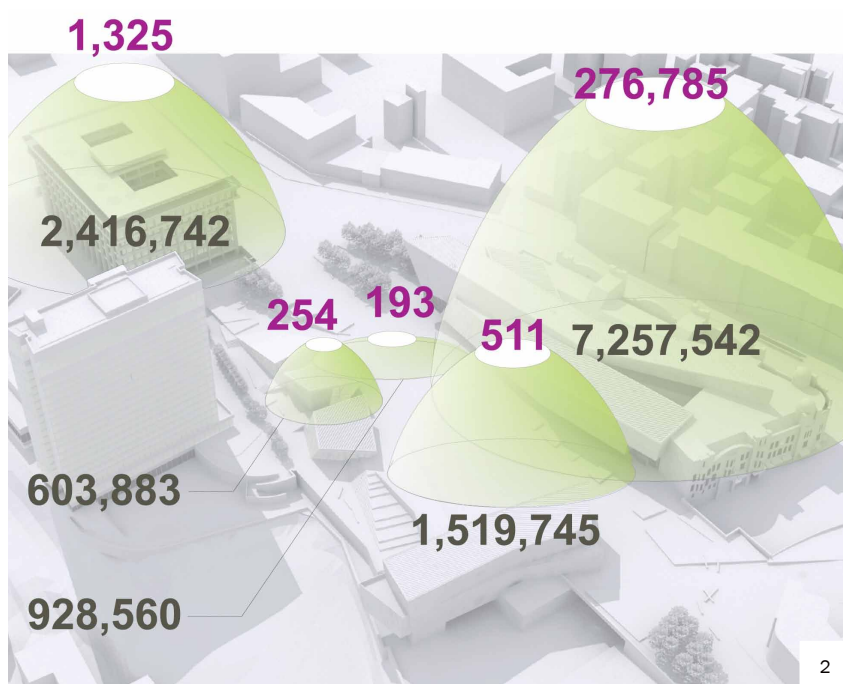

### 1 AERIAL VIEW

LAB architect's model of the new Square of the Rose Revolution.

### 2 ELECTRICAL POWER + ELECTRICAL LOADS

Integrated, site-wide load analysis allows design resources to be targeted at the area where maximum benefit can be achieved.